

# NIMH - TECHNICAL DATA SHEET - MODEL ESP13000FH

TECHNICAL DATA SHEET

## Battery General Specification :

**Model** - ESP13000FH  
**Chemical Material** - Nickel Metal Hydride.  
**Description** - 1.2v Rechargeable battery  
 F size.

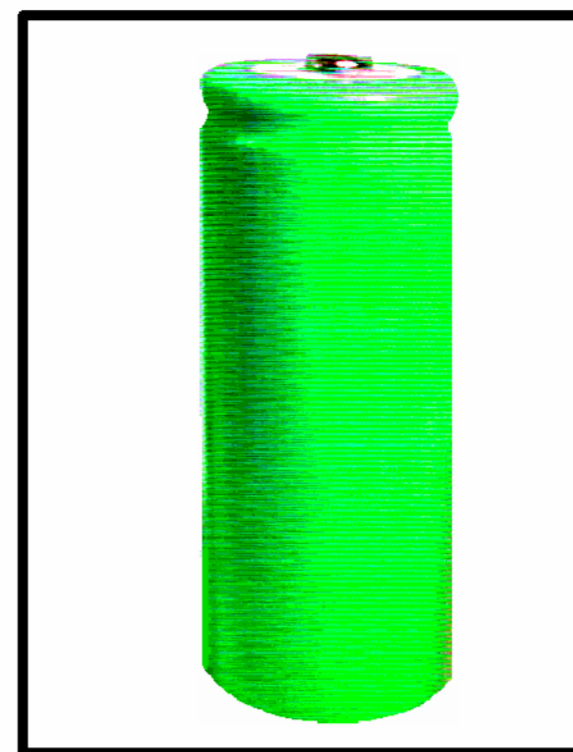

### Discharging:

#### (A) Discharge current.

- 1/ Discharged at 0.2CA, Provide 80% at EPV 1.2V 98% of nominal capacity at EPV 1.1V.
- 2/ Discharged at 0.5CA, Provide 70% at EPV 1.2V 95% of nominal capacity at EPV 1.1V.
- 3/ Discharged at 1CA, Provide 60% at EPV 1.2V 93% of nominal capacity at EPV 1.1V.
- 4/ Discharged continuously at 1C, for 2 hours, No explosion or leakage.

#### (B) Capacity and Cycle ( 500 to 800 cycles)

Charge at 0.1C, discharge at 0.2C; 100% nominal capacity.

Charge at 1C, discharge at 1C; minimum 95% nominal capacity.

### Physical and Electrical Specifications.

DIMENSIONS WITH SLEEVE

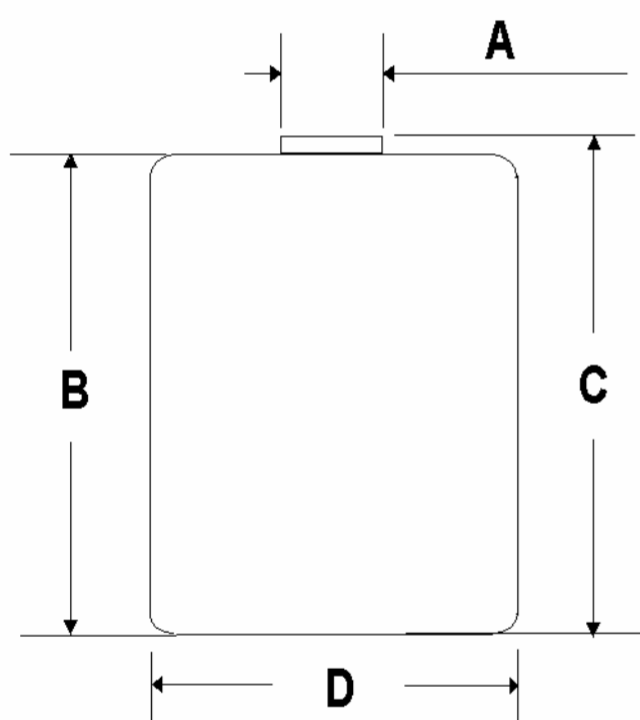

<b>A</b>	08.0mm +/- 0.2mm
<b>B</b>	
<b>C</b>	90.5mm +/- 0.5mm
<b>D</b>	32.3mm +/- 0.2mm

Nominal Voltage		1.2v
Typical Capacity		13000mAh
Weight		255g
Internal resistance.		6.5m Ω
Charge	Standard	1300mA x 15hrs
	Quick	3900mA x 4hrs

Ambient temperature	Charge	Standard	0°C to 45°C
		Quick	10°C to 45°C
	Discharge		-30°C to 60°C
	Storage		-30°C to 65°C

### Discharge Temperature at 0.2CA

- 1/ At 20°C, 100% nominal capacity.
- 2/ At 0°C, 90% nominal capacity.
- 3/ At 60°C, Or -20°C, 85% nominal capacity.
- 4/ Charge retention for 30 days at 20°C, cell can provide 70% nominal capacity discharged at 0.2CA.

**CELLS MANUFACTURED TO GB/T19001:2000 - ISO9000/9001: 2000 STANDARD & CONFORMITY**  
 Cell & Battery specifications are subject to modifications without prior notice. All the above information is generally descriptive and is not intended as a guarantee or warranty.

**ESP** SPECIAL BATTERIES LTD  
 565 Uppingham Rd  
 Leicester. LE5 6QA  
 England.

Tel 0116 2413796  
 Fax 0116 2416519  
 Email - info@espspecialbatteries.co.uk

ESP13000FH